

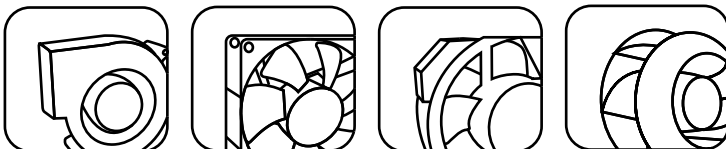

AC IMPELLER

CROWN PELECTRONICS











● PRODUCT FLOW LINE



<http://www.crownelectronics.com.tw>

Ver.02

CROWN AC Impeller

Frame size \ Air flow (CFM)	200	250	300	400	500	600	700	800	900	1000
Ø133mm		91mm								
Ø175mm				68mm 74.4mm						
Ø190mm				74.4mm						
Ø200mm					74.4mm					
Ø220mm						74.4mm				
Ø225mm							74.4mm			
Ø250mm								74.4mm		
Ø280mm									74.4mm	
Ø310mm										74.4mm 74.4mm

Application

- Thermal exchange kit
- Cooling fan
- CNC machine cooling
- Clean roon ventilator

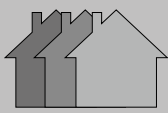
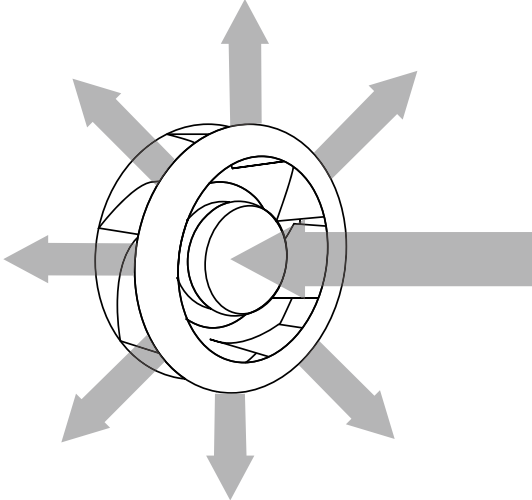
175 JGN Series

Size (尺寸) 175*69

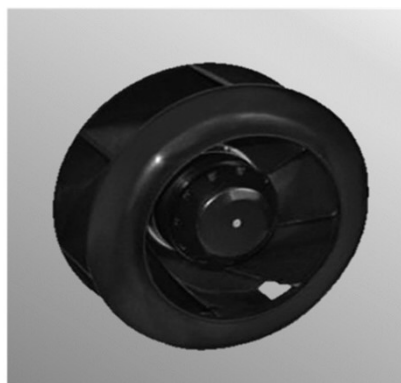

General Specifications (一般規格)

- ★ Motor : Capacitor AC motor. ★ 馬達 / 交流電容式馬達
- ★ Frame : Aluminum ★ 材料 / 框 : 鋁
- ★ Impeller : Plastic (94V-0) ★ 材料 / 葉 : 塑膠 (94V-0)
- ★ Bearing : Ball Bearing ★ 軸承 / 滾珠軸承
- ★ Weight : 1 Kg ★ 重量 / 1 公斤
- ★ IPXX Rank : IP43 ★ 防水等級 : IP43

Major Characteristic Parameters

Model	Bearing System	Rated Voltage	Freq.	Input Power	Rated Speed	Maximum Air Flow		Maximum Static Pressure		Sound Level	Weight
						m3/min	CFM	mm-H2O	in-H2O		
JGN17569B2H	B	220	50 / 60	48 / 46	2500 / 2700	6.7 / 7.3	237.8 / 256.8	26.5 / 30.9	1.04 / 1.22	62 / 62	1.00
JGN17569B1H	B	110	50 / 60	48 / 46	2500 / 2700	6.7 / 7.3	237.8 / 256.8	26.5 / 30.9	1.04 / 1.22	62 / 62	1.00

*All reading are typical values at rated voltage

*Specifications are subject to change without notice

* Bearing system B: Two Ball Bearing S: Sleeve Bearing

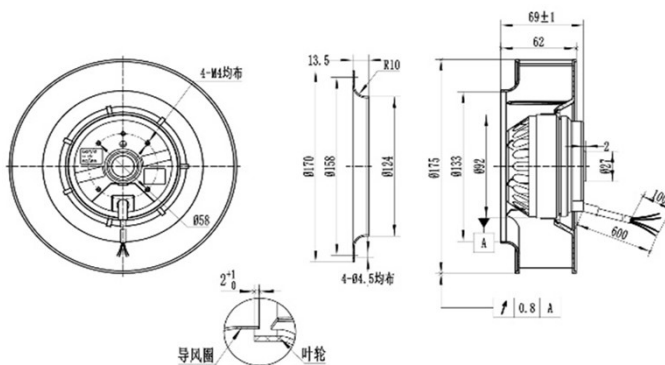
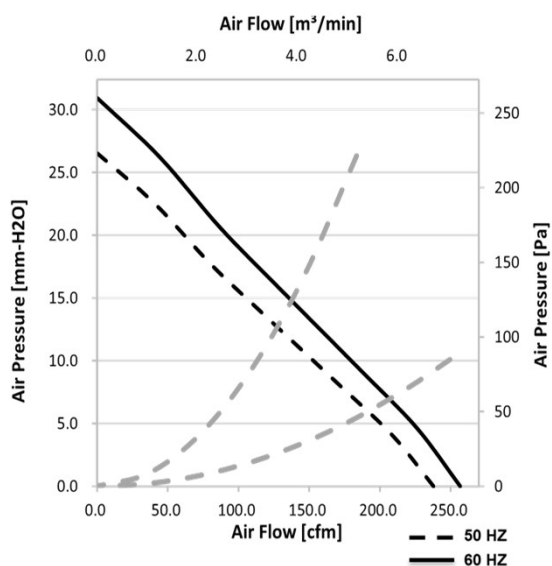

190 JGN Series

Size (尺寸) 190*69

General Specifications (一般規格)

- ★ Motor : Capacitor AC motor. ★ 馬達 / 交流電容式馬達
- ★ Frame : Aluminum ★ 材料 / 框 : 鋁
- ★ Impeller : Plastic (94V-0) ★ 材料 / 葉 : 塑膠 (94V-0)
- ★ Bearing : Ball Bearing ★ 軸承 / 滾珠軸承
- ★ Weight : 1.2 Kg ★ 重量 / 1.2 公斤
- ★ IPXX Rank : IP43 ★ 防水等級 : IP43



Major Characteristic Parameters

Model	Bearing System	Rated Voltage	Freq.	Input Power	Rated Speed	Maximum Air Flow		Maximum Static Pressure		Sound Level	Weight
						m3/min	CFM	mm-H2O	in-H2O		
JGN17569B2H	B	220	50 / 60	68 / 80	2500 / 2800	8.1 / 9.1	287 / 322	32.7 / 41.0	1.29 / 1.61	65 / 65	1.20
JGN17569B1H	B	110	50 / 60	68 / 80	2500 / 2800	8.1 / 9.1	287 / 322	32.7 / 41.0	1.29 / 1.61	65 / 65	1.20

*All reading are typical values at rated voltage

*Specifications are subject to change without notice

* Bearing system B: Two Ball Bearing S: Sleeve Bearing

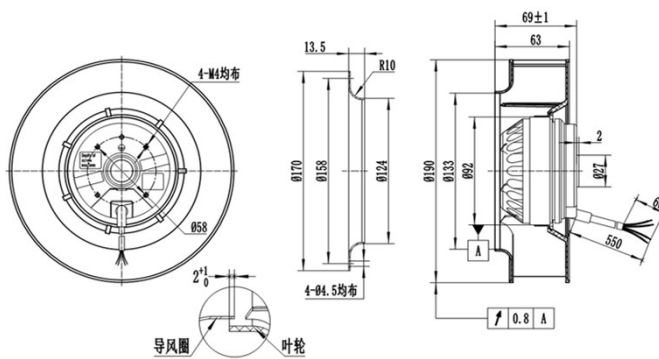
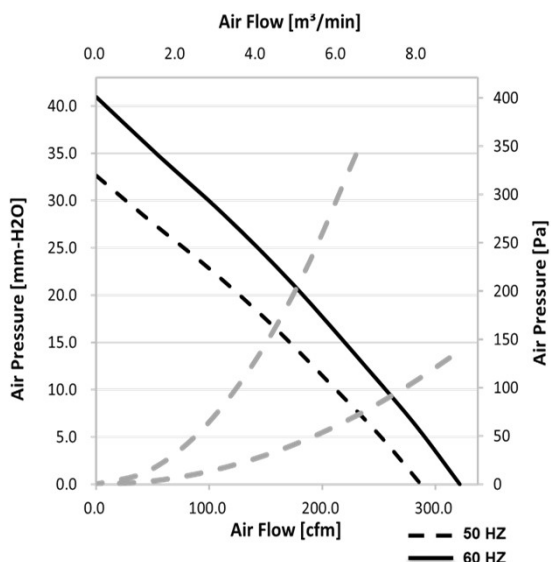

220

JGN Series

Size (尺寸) 220*71

General Specifications (一般規格)

- ★ Motor : Capacitor AC motor. ★ 馬達 / 交流電容式馬達
- ★ Frame : Aluminum ★ 材料 / 框 : 鋁
- ★ Impeller : Plastic (94V-0) ★ 材料 / 葉 : 塑膠 (94V-0)
- ★ Bearing : Ball Bearing ★ 軸承 / 滾珠軸承
- ★ Weight : 1.4 Kg ★ 重量 / 1.4 公斤
- ★ IPXX Rank : IP43 ★ 防水等級 : IP43



Major Characteristic Parameters

Model	Bearing System	Rated Voltage	Freq.	Input Power	Rated Speed	Maximum Air Flow		Maximum Static Pressure		Sound Level	Weight
						m3/min	CFM	mm-H2O	in-H2O		
JGN22071B2H	B	220	50 / 60	95 / 100	2500 / 2700	12.8 / 13.8	452 / 489	36.7 / 42.8	1.45 / 1.69	70 / 72	1.40
JGN22071B1H	B	110	50 / 60	95 / 100	2500 / 2700	12.8 / 13.8	452 / 489	36.7 / 42.8	1.45 / 1.69	70 / 72	1.40

*All reading are typical values at rated voltage

*Specifications are subject to change without notice

* Bearing system B: Two Ball Bearing S: Sleeve Bearing

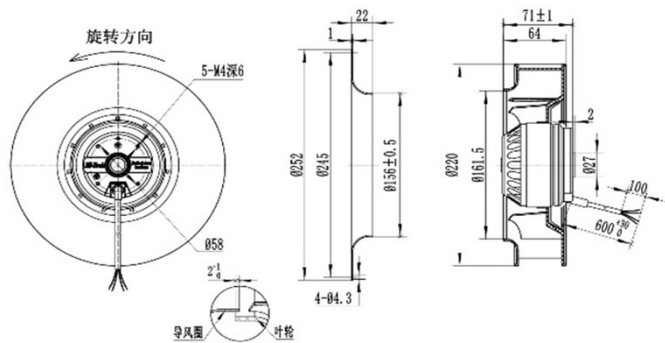
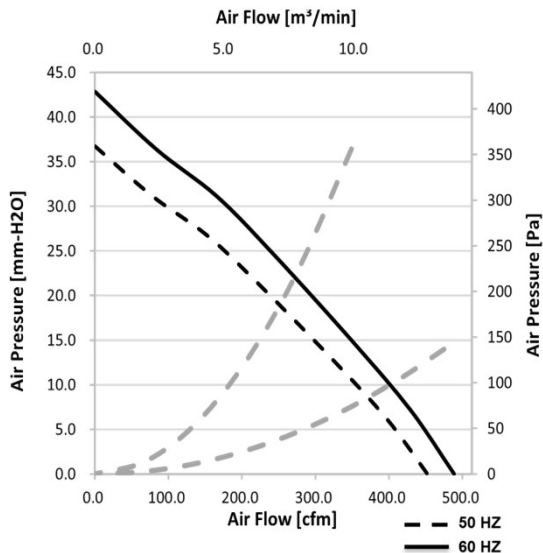

225 JGN Series

Size (尺寸) 225*99

General Specifications (一般規格)

- ★ Motor : Capacitor AC motor. ★ 馬達 / 交流電容式馬達
- ★ Frame : Aluminum ★ 材料 / 框 : 鋁
- ★ Impeller : Plastic (94V-0) ★ 材料 / 葉 : 塑膠 (94V-0)
- ★ Bearing : Ball Bearing ★ 軸承 / 滾珠軸承
- ★ Weight : 2.3 Kg ★ 重量 / 2.3 公斤
- ★ IPXX Rank : IP43 ★ 防水等級 : IP43



Major Characteristic Parameters

Model	Bearing System	Rated Voltage	Freq.	Input Power	Rated Speed	Maximum Air Flow		Maximum Static Pressure		Sound Level	Weight
						m3/min	CFM	mm-H2O	in-H2O		
Part NO.	B / S	V	Hz	WATT	RPM					dBA	Kg
JGN22599B2H	B	220	50 / 60	105 / 110	2500 / 2700	16.1 / 17.4	568 / 614	50.0 / 58.3	1.97 / 2.30	70 / 72	2.30
JGN22599B1H	B	110	50 / 60	105 / 110	2500 / 2700	16.1 / 17.4	568 / 614	50.0 / 58.3	1.97 / 2.30	70 / 72	2.30

*All reading are typical values at rated voltage

*Specifications are subject to change without notice

* Bearing system B: Two Ball Bearing S: Sleeve Bearing

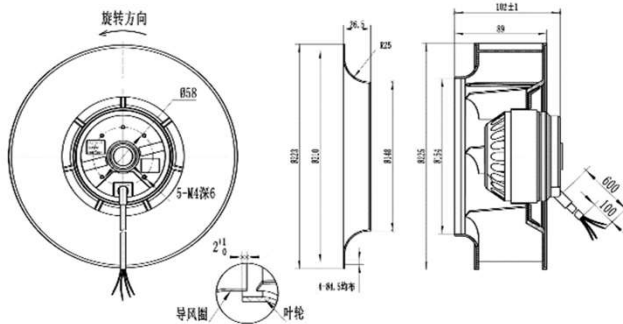
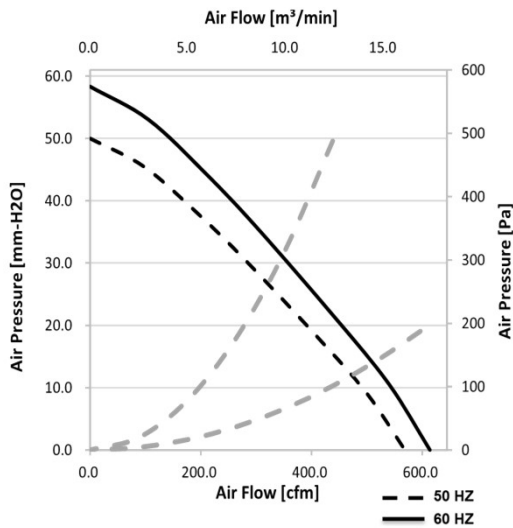

250

JGN Series

Size (尺寸) 250*99

General Specifications (一般規格)

- ★ Motor : Capacitor motor. ★ 馬達 / 交流電容式馬達
- ★ Frame : Plastic (94V-0) ★ 材料 / 框 : 塑膠 (94V-0)
- ★ Impeller : Plastic (94V-0) ★ 材料 / 葉 : 塑膠 (94V-0)
- ★ Bearing : Ball Bearing ★ 軸承 / 滾珠軸承
- ★ Weight : 2.7 Kg ★ 重量 / 2.7 公斤
- ★ IPXX Rank : IP43 ★ 防水等級 : IP43



Major Characteristic Parameters

Model	Bearing System	Rated Voltage	Freq.	Input Power	Rated Speed	Maximum Air Flow		Maximum Static Pressure		Sound Level	Weight
						m3/min	CFM	mm-H2O	in-H2O		
Part NO.	B / S	V	Hz	WATT	RPM					dBA	Kg
JGN25099B2H	B	220	50 / 60	160 / 165	2400 / 2600	21.0 / 22.8	742 / 804	58.2 / 68.3	2.29 / 2.69	68 / 70	2.70
JGN25099B1H	B	110	50 / 60	160 / 165	2400 / 2600	21.0 / 22.8	742 / 804	58.2 / 68.3	2.29 / 2.69	68 / 70	2.70

*All reading are typical values at rated voltage

*Specifications are subject to change without notice

* Bearing system B: Two Ball Bearing S: Sleeve Bearing

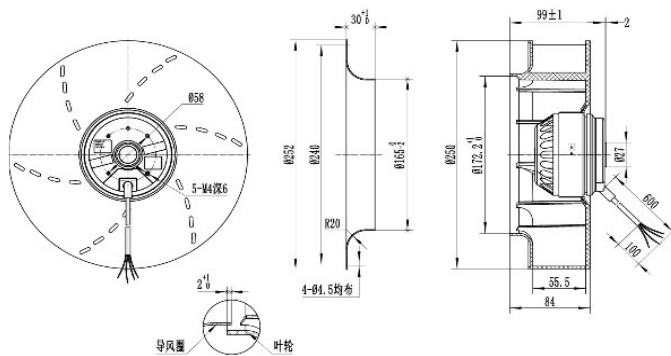
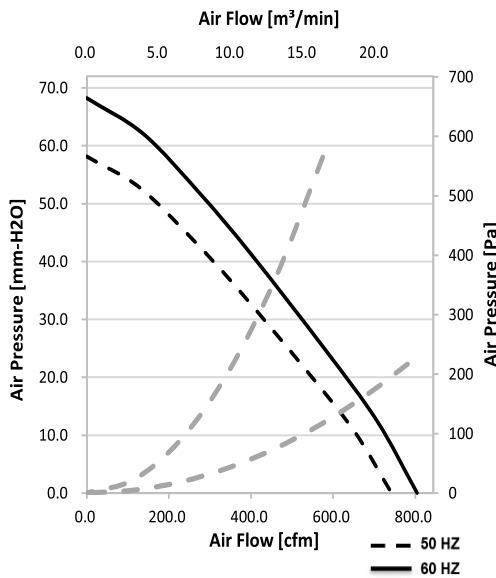

280

JGN Series

Size (尺寸) $\phi 300 \times 105$

General Specifications (一般規格)

- ★ Motor : Capacitor motor. ★ 馬達 / 交流電容式馬達
- ★ Frame : Aluminum ★ 材料 / 框 : 鋁
- ★ Impeller : Metal SPCC ★ 材料 / 葉 : 鋼鐵
- ★ Bearing : Ball Bearing ★ 軸承 / 滾珠軸承
- ★ Weight : 3.6 Kg ★ 重量 / 3.6 公斤
- ★ IPXX Rank : IP44 ★ 防水等級 : IP44



Major Characteristic Parameters

Model	Bearing System	Rated Voltage	Freq.	Input Power	Rated Speed	Maximum Air Flow		Maximum Static Pressure		Sound Level	Weight
						m3/min	CFM	mm-H2O	in-H2O		
JGN28099B2H	B	230	50 / 60	100 / 120	1400 / 1600	28.5 / 33.3	1007 / 1177	35.0 / 40.0	1.38 / 1.57	62 / 66	3.60
JGN28099B3H	B	380	50 / 60	100 / 120	1400 / 1600	28.5 / 33.3	1007 / 1177	35.0 / 40.0	1.38 / 1.57	62 / 66	3.60

*All reading are typical values at rated voltage

*Specifications are subject to change without notice

* Bearing system B: Two Ball Bearing S: Sleeve Bearing

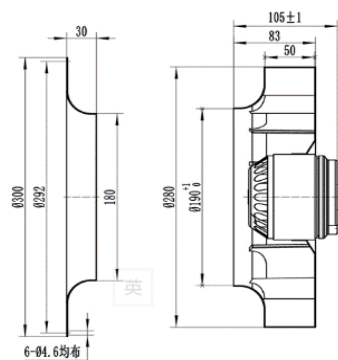
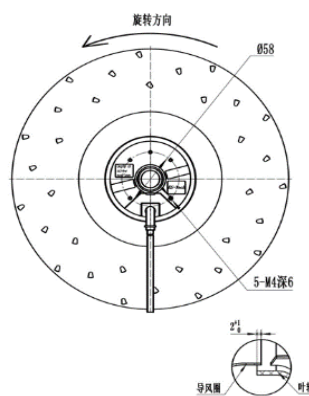
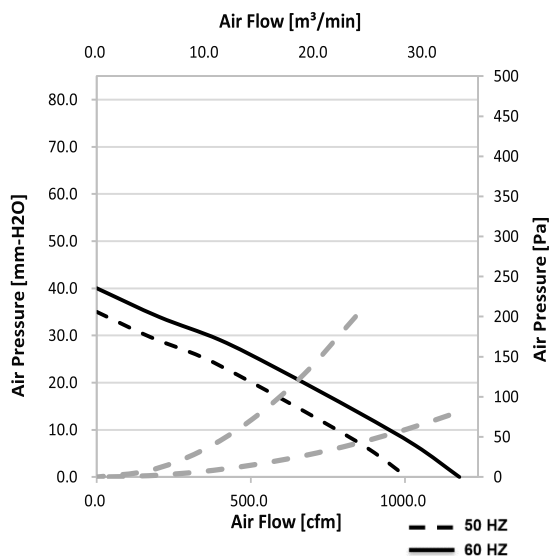

Plug Cord

180° type

Model:CP01-1
Rohs compliance

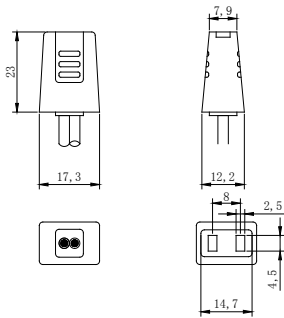

90° type

Model:CP01-2
Rohs compliance

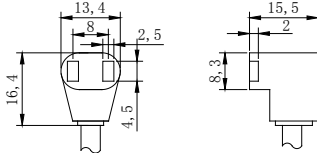

45° type

Model:CP01-3
Rohs compliance

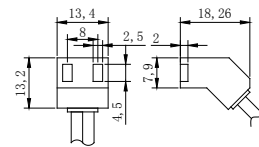

Rubber Fan Mount

General Specification

Model:Ruber
Application: 40X40mm to 120mmX120mm DC axial fans
Rohs compliance

A type

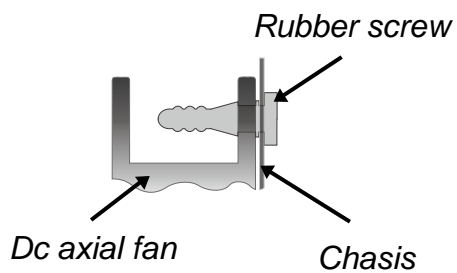

B type

